

8100/9100 Series Parts

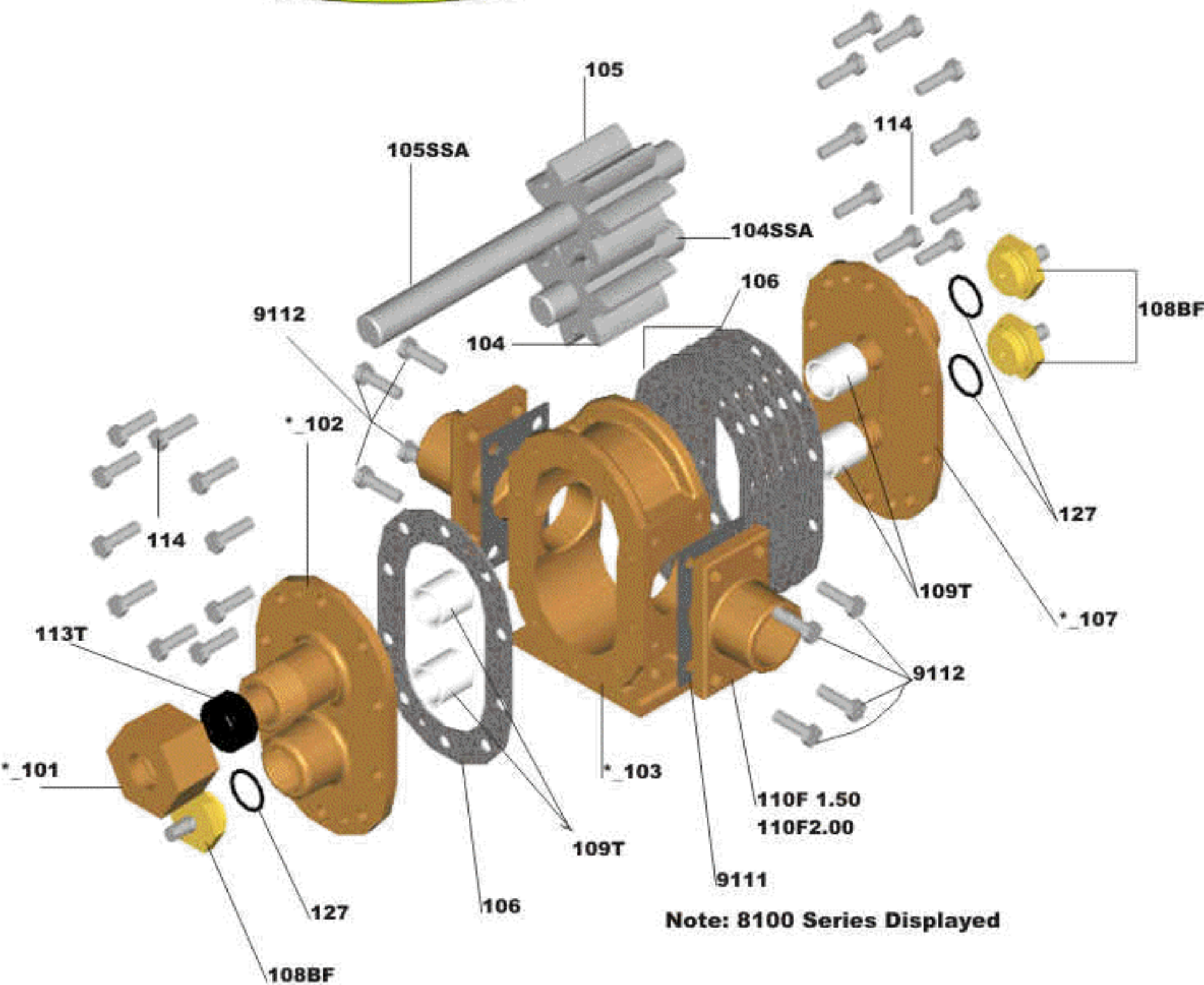

No	Stock No.	Description	Qty	No	Stock No.	Description	Qty	No	Stock No.	Description	Qty
1	104	Gear, Idler	1	8	108	End Plug	3	14	-101	Nut, Packing	1
2	104K	Key Gear	2		108BF	End Plug W/Ftg. Opt. ¹	(3)	15	-102	Plate, Front	1
3	104 SSA	Shaft, Idler	1	9	109T	Bushing, Teflon	4	16	-103	Case, Center	1
4	105	Gear, Drive	1	10	113T	Packing, Teflon	1	17	-107	Plate Back	1
5	105 SSA	Shaft, Drive	1	11	114	Bolt, End Plate	20		110F 1.50	Flange Adapter	**
6	106	Gasket, Plate	8	12	116	Fitting, Grease Opt. ¹	(3)		110F 2.00	Flange Adapter	**
7	107 HP	Wear Plate **	2	13	127	O'ring	3		9111	Flange Gasket	
						** Optional			9112	Bolt Flange	

Use 8 for first number if Alum/Bronze Use 9 for first number if Cast Iron

